



MI Home, Indiranagar, Bangalore

A LEED CI-Retail GOLD Certified



GreenTree Global: Nidhi Khosla, Vertika Pandey, Jeyaraj K.

“...70% of the decisions associated with environmental impacts are made during the first 10% of the design process.”



Green buildings are an integral part of the solution to the environmental challenges facing by the planet earth. The philosophy of **GreenTree Global** is rooted in the concept of creating healthier spaces with minimal environmental impact. We are delighted to have played a role in extending our services (from design to occupancy stage) to our end client Xiaomi India for their retail outlet in Bangalore, India through 4D.

GreenTree along with one of the best Retail Design firm Four Dimensions (4D), have made the design decisions to enhance the building performance and to make the third retail store in India achieving LEED Gold rating.

MI Home has been designed to deliver various benefits like.....



The flagship retail outlet MI Home at Indiranagar, Bangalore has followed LEED CI-retail to optimize the use of natural resources, promote regenerative strategies, maximize the positive and minimize the negative environmental and human health consequences of the construction practices, and provide high-quality indoor environments for building's Mi employees and visitors.

Main green features incorporated in MI Home are:

The project is well located space & taking advantage of existing infrastructure- public transport, services & amenities.



The store has offset 14.5% of the total energy costs through renewable energy generated on-site by installed solar PV panels.



The retail outlet is located within 170 meter walking distance from Old Police Station bus Stop, and 210 meters walking distance from Indiranagar KFC bus stop



Project has provided bicycle storage spaces to support users seeking transportation options.



The approach towards conserving water is to have efficient plumbing fixtures installed. Potable water use reduction is the actual water savings. The recommended and installed efficient fixtures have the following flow rates,

- Dual Flush water closet- 4/2 LPF
- Urinals – 0.8 LPF
- Faucets- 1.92 LPM

The efficient plumbing fixtures at the store can save water upto 35000 litres/annum, i.e, 52% water saving achieved when compared with conventional fixtures.



The water saved by the store can fulfill the drinking water requirement of 8 families for the whole year.

The store demonstrates an energy cost savings of 16.5% and the annual energy consumption predicted for the project is 76,442 kWh/year of electricity. The envelop components include,

Wall: 200mm AAC Block; U-value= 0.1 Btu/hr sqft F
Roof: 400mm RCC slab; U-value= 0.138 Btu/hr sqft F
Glazing: U-value= 0.33 Btu/hr sqft F, VLT= 57% and SHGC= 0.47



90.18% of construction waste has been diverted from landfill by reusing/ recycling. 100% of all paints, adhesives, and sealants used in building interior are low VOC. 100% of all composite wood products are free from urea-formaldehyde.

Although the project could not take the benefits on material credentials as per LEED 4.1 credit requirements.



The store prohibits the smoking in its premises. It ensures that the signage system communicates well to occupants that smoking is prohibited. The ventilation system that supplies outdoor air to occupied spaces of the store has filtration media with a minimum efficiency reporting value (MERV) of 13



The store is designed such that it receives adequate daylight of 300 lux that illuminates 90% of the *regularly* occupied spaces.

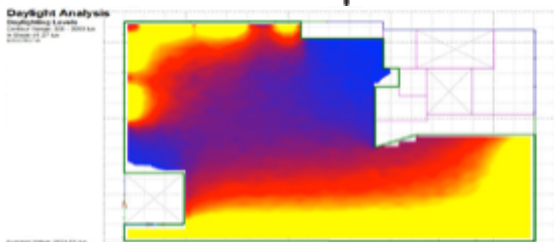

GreenTree Global, yet again, is proud to make a great contribution in addressing environmental challenges and create a healthier and productive space for our clients.